



Designed for the
future

Creating a sustainable legacy together:

Determined to reduce our environmental footprint, we aim to be CO₂-neutral by 2050. A circular economy, innovation and smart use are the stepping stones on our path.
It is time to act, join us now!

Lower CO₂ equivalents and market-leading versatility

Life is more rewarding with the new VRV 5.

Our new all-round performer covers all of your mini VRV applications in Daikin's most sustainable solution.

- › **Maximum flexibility** allowing installation in rooms down to 10 m² thanks to Shîrudo technology
- › **Top sustainability** over the entire lifecycle thanks to low GWP R-32 refrigerant and market-leading real life seasonal efficiency
- › **Ergonomic serviceability** and handling, thanks to wide access area to easily reach components within low-profile single fan casing
- › **Best-in-class design versatility** with five sound pressure levels down to 39 dB(A) and automatic ESP setting up to 45 Pa allowing ductwork
- › **Geared for comfort** with intuitive online and voice controls plus a new 10 class indoor unit for small rooms

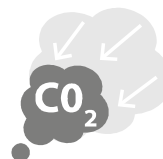

VRV 5

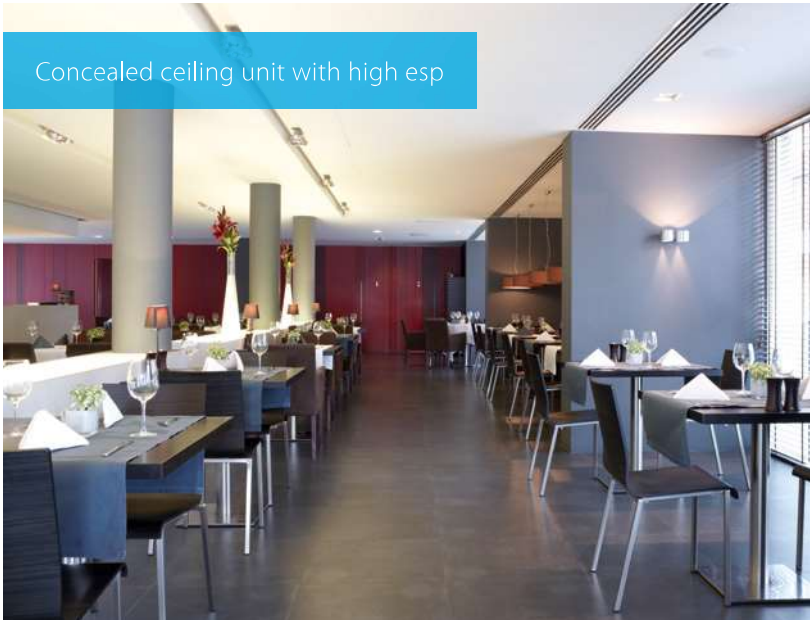



INTRODUCTION

RESIDENTIAL
INDOOR AIR
QUALITY

HEATING

SPLIT

SKY AIR

ROOFTOP

VRV

COMMERCIAL
VENTILATION &
AIR PURIFICATION

MARINE
INDUSTRY

CHILLERS

FAN COIL
UNITS

AIR HANDLING
UNITS

COMMERCIAL &
TRANSPORT
REFRIGERATION

Fully flat cassette

Fully Flat Cassette

Design & Genius in one



Why choose fully flat cassette

- › Unique design in the market that integrates fully flat into the ceiling
- › Advanced technology and top efficiency combined
- › Most quiet cassette available on the market

FXZQ-A



Benefits for the installer

- › Unique product in the market!
- › Most quiet unit (25dBA)
- › The user-friendly remote control, available in several languages, enables the easy set-up of sensor option and control of the individual flap position
- › Meeting European design taste.

Benefits for the consultant

- › Unique product in the market!
- › Blends seamlessly in any modern office interior design
- › Ideal product to improve BREEAM score/EPBD in combination with Sky Air (FFA*) or VRV IV heat pump units (FXZQ*).

Benefits for the end user

- › Engineering excellence and unique design in one
- › Most quiet unit (25dBA)
- › Perfect working conditions: no more cold draughts
- › Save up to 27% on your energy bill thanks to the optional sensors
- › Flexible usage of space and suits any room configuration thanks to individual flap control
- › User-friendly remote control, available in several languages.

Fully flat cassette

Unique design in the market that integrates fully flat into the ceiling

- › Optimised design for R-32 refrigerant
- › Fully flat integration in standard architectural ceiling tiles, leaving only 8mm
- › Remarkable blend of iconic design and engineering excellence with an elegant finish in white or a combination of silver and white
- › Two optional intelligent sensors improve energy efficiency and comfort
- › 15 class unit especially developed for small or well-insulated rooms, such as hotel bedrooms, small offices, etc.
- › Individual flap control: flexibility to suit every room layout without changing the location of the unit!

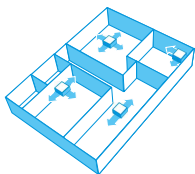

- › Optional fresh air intake
- › Standard drain pump with 630mm lift increases flexibility and installation speed

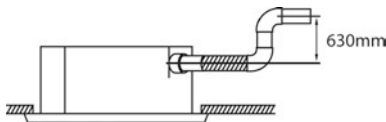

More details and final information can be found by scanning or clicking the QR codes.



Indoor Unit		FXZA		15A	20A	25A	32A	40A	50A	
Cooling capacity	Total capacity	At high fan speed	kW	1.70	2.20	2.80	3.60	4.50	5.60	
	Heating capacity	Total capacity	At high fan speed	kW	1.90	2.50	3.20	4.00	5.00	6.30
Power input - 50Hz	Cooling	At high fan speed	kW	0.018		0.020	0.019	0.029	0.048	
	Heating	At high fan speed	kW	0.018		0.020	0.019	0.029	0.048	
Dimensions	Unit	HeightxWidthxDepth	mm	260x575x575						
Weight	Unit		kg	15.5			16.5		18.5	
Casing	Material	Galvanised steel plate								
Decoration panel	Model	BYFQ60C4W1W								
	Colour	White (N9.5)								
	Dimensions	HeightxWidthxDepth	mm	46x620x620						
	Weight		kg	2.8						
Decoration panel 2	Model	BYFQ60C4W1S								
	Colour	SILVER								
	Dimensions	HeightxWidthxDepth	mm	46x620x620						
	Weight		kg	2.8						
Decoration panel 3	Model	BYFQ60B3W1 + wire harness EKRS23								
	Colour	WHITE (RAL9010)								
	Dimensions	HeightxWidthxDepth	mm	55x700x700						
	Weight		kg	2.7						
Fan	Air flow rate - 50Hz	Cooling	At high / medium / low fan speed	m³/min	8.5/7.0/6.5	8.7/7.5/6.5	9.0/8.0/6.5	10.0/8.5/7.0	11.5/9.5/8.0	14.0/12.5/10.0
		Heating	At high / medium / low fan speed	m³/min	8.5/7.0/6.5	8.7/7.5/6.5	9.0/8.0/6.5	10.0/8.5/7.0	11.5/9.5/8.0	14.0/12.5/10.0
Air filter	Type	Resin net								
Sound power level	Cooling	At high fan speed	dBA	49		50	51	54	60	
Sound pressure level	Cooling	At high / medium / low fan speed	dBA	31.5/28.0/25.5	32.0/29.5/25.5	33.0/30.0/25.5	33.5/30.0/26.0	37.0/32.0/28.0	43.0/40.0/33.0	
	Heating	At high / medium / low fan speed	dBA	31.5/28.0/25.5	32.0/29.5/25.5	33.0/30.0/25.5	33.5/30.0/26.0	37.0/32.0/28.0	43.0/40.0/33.0	
Refrigerant	Type/GWP	R-32/675.0								
Piping connections	Liquid	OD	mm	6.35						
	Gas	OD	mm	9.52				12.70		
	Drain			VP20 (I.D. 20/O.D. 26)						
Power supply	Phase/Frequency/Voltage	Hz/V	1~/50/60/220-240/220							
Current - 50Hz	Maximum fuse amps (MFA)	A	6							
Control systems	Infrared remote control		BRC7F530W (white panel) / BRC7F530S (grey panel) / BRC7EB530W (standard panel) (1)							

